

## DIAPHRAGM SENSING PRESSURE REDUCING VALVE PRV 30SS DN 1/2" – 3/4"; DN15 – DN20

### DESCRIPTION

The ADCA PRV30 series **direct acting, spring-loaded diaphragm sensing, balanced valve** pressure reducing valves, are designed for use on compressed air, water and other gases or liquids compatible with the materials of construction .

They are suitable for pressure reducing stations at the point of use on laundry machines, dyeing, food industries, sterilizers, etc.

### MAIN FEATURES

Compact design.  
Balanced valve.  
Machined from barstock materials or investment casting.



**OPTIONS:**

- Different soft valves for water and gases.
- Relieving-Internal relief valve to allow reduce outlet pressure in a no-flow condition.
- Built-in strainer.
- Outlet 1/4" gauge connection on body.
- Regulating screw with top cap.

**USE:** Compressed air, water and other gases and liquids compatible with the construction.

**AVAILABLE MODELS:** PRV30/SS – Stainless steel.

**SIZES:** DN 1/2" and DN 3/4"  
DN 15 and DN 20

**CONNECTIONS:** Female screwed ISO7/1Rp(BS 21) or NPT.  
Flanged EN 1092-1 PN40-PN63.  
Special flanges upon request.

**INSTALLATION:** Horizontal installation.  
An "Y" strainer should be provided upstream the valve.  
See IMI, installation and maintenance instructions.

**ORDER REQUIREMENTS :**

- Type of fluid
- Maximum operating temperature
- Inlet pressure and required outlet pressure
- Capacity (maximum and minimum).

CAPACITIES		
Valve Size	15	20
KVs (m3/h)	2,1	2,4

LIMITING CONDITIONS	
Valve model	PRV30SS
Body design conditions	PN 63
Max.upstream pressure	50 bar
Max.downstream pressure	15 bar
Min.downstream pressure	0,2 bar
Max.design temperature *	80 °C
Max.recommended reducing ratio	40:1

\*Other on request.

CE MARKING (PED - European Directive 97/23/EC)	
PN 16-PN63	Category
DN 15 to 20	SEP - art. 3, paragraph3

DIMENSIONS (mm)										
Screwed					EN 1092-1 Flg.PN16/PN40			EN 1092-1 Flg.PN63/PN100		
SIZE DN	A	B	C	WGT. Kgs	D*	E	WGT. Kgs	D*	E	WGT. Kgs
1/2"-15	80	38	142	1,8	150	47,5	3,2	210	52,5	4
3/4"-20	80	38	142	1,8	150	52,5	3,8	230	70	6

\* Different lengths and connections on request.

Note: DN15 PN16/40 face to face dim. was adopted as per DN20

DN 1" or DN 25 available on special execution and same performance

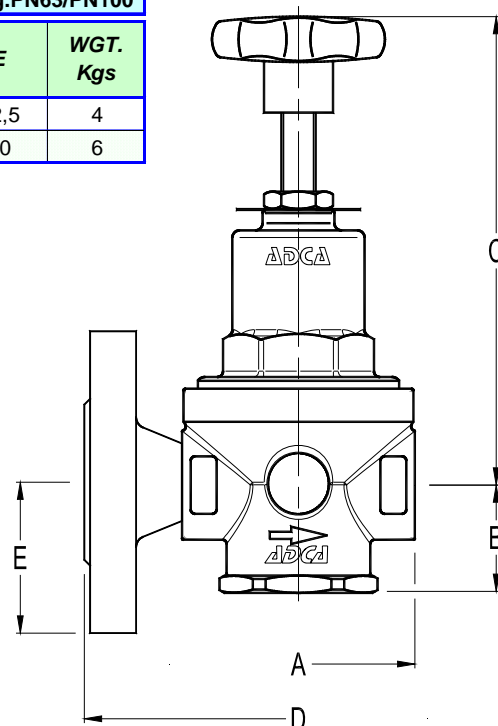

MATERIALS		
POS.	DESIGNATION	MATERIAL
1	a) VALVE BODY	AISI316 / 1.4401 ; CF8M / 1.4408
2	a) TOP COVER	AISI316 / 1.4401 ; CF8M / 1.4408
3	SEAT COVER	AISI316 / 1.4401 ; CF8M / 1.4408
4	* O-RING	NBR
5	* PISTON VALVE	AISI316 / 1.4401
6	* VALVE HEAD	NBR-EPDM-PTFE,etc
6A	PUSHROD	AISI316 / 1.4401
7	* O-RING	NBR-EPDM-PTFE,etc
8	* VALVE SPRING	AISI302 / 1.4300
8A	* STRAINER SCREEN	AISI304 / 1.4301
9	PUSHER DISC	AISI304 / 1.4301
10	* DIAPHRAGM	PTFE
11	* DIAPHRAGM	**NBR
12	GASKET	**ALUMINIUM
13	SPRING PLATE	AISI304 / 1.4301
14	NUT	ST.STEEL A2-70
15	* ADJUSTMENT SPRING	SPRING STEEL
16	TOP SPRING PLATE	BRASS
17	ADJUSTMENT SCREW	AISI304 / 1.4301
18	LOCKNUT	ST.STEEL A2-70
19	HANDWHEEL	PLASTIC
20	SPRING IDENT. PLATE	ALUMINIUM

\* Available spare parts. \*\* Stainless steel on request .

Remarks: All valves have a serial number. In case of non-standard valves this number must be supplied if spare parts are ordered.

**Note:** Barstock execution on request.

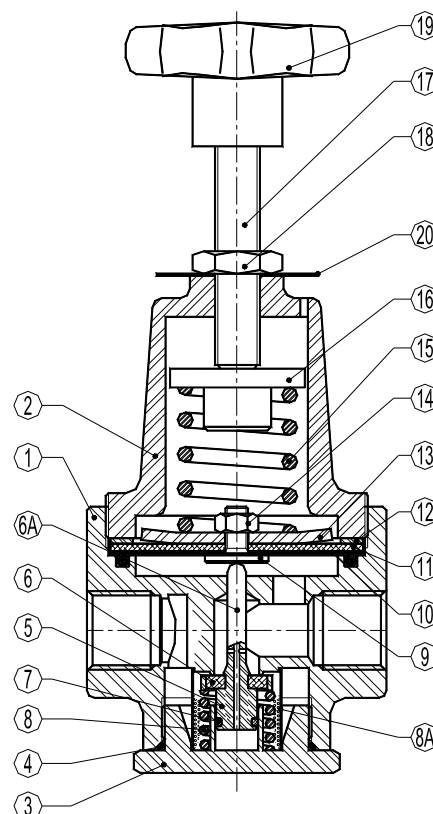

## ORDERING CODES PRV30SS

<b>Valve Model</b>	<b>R30</b>	<b>.</b>	<b>1</b>	<b>W</b>	<b>N</b>	<b>C</b>	<b>R</b>	<b>.</b>	<b>15</b>
PRV30SS - Diaphragm sensing	R30								
<b>Outlet spring range</b>									
Nº1 - 0,2 to 1,5 bar			1						
Nº2 - 0,3 to 3 bar			2						
Nº3 - 0,8 to 8 bar			3						
Nº4 - 1,5 to 15 bar			4						
<b>Aplication</b>									
Water				W					
Gases				G					
Oxygen (Degreased)				O					
<b>Seal material</b>									
NBR					N				
EPDM					E				
PTFE					T				
FPM/VITON					V				
<b>Maximum inlet pressure</b>									
30 bar						C			
50 bar a)						D			
<b>Diaphragm material</b>									
Stainless steel (Non-relieving)						S			
Rubber/PTFE (Relieving or non-relieving)						R			
<b>Gauge port 1/4"</b>									
Without gauge ports							(1)		
Gauge port on the left side (Related to the flow direction)							4		
Gauge port on the right side (Related to the flow direction)							3		
Gauge ports on both sides							2		
<b>Relieving</b>									
Non-relieving								(1)	
Relieving (Only for non-dangerous gases)								R	
<b>Pipe connection</b>									
Threaded BSP ISO 7/1 Rp								A	
Threaded NPT ANSI B1.20.1								C	
Socket weld SW ANSI B16.11								H	
Butt weld BW ANSI B16.25								I	
Flanged EN1092-1 PN40								N	
Flanged EN1092-1 PN63								O	
Flanged ANSI B16.5 150#								U	
Flanged ANSI B16.5 300#								V	
Flanged ANSI B16.5 600#								W	
<b>Size</b>									
DN 1/2" or DN 15									15
DN 3/4" or DN 20									20
DN 1" or DN 25 (same performance but larger connection - special execution)									25E
<b>Special valves / Extras b)</b>									
									E

(1) Omitted if a standard valve is requested

a) The 50 bar inlet available only with spring Nº4

b) Full description or additional codes have to be added in case of non-standard combination.