

PROINVAL GATE VALVE NP 16 SCREWED ENDS DIN NP 10/16

BVP-70RI

BV Proinval gate valves BVP-70RI are used in many industrial installations. Their conception allows working with aggressive fluids and in the most demanding conditions.

RANGE: from ND1/2" up to ND2".
SCREWED BSP: DIN259/2999 (BSP).



ND	L	H	W	Kgs.
1/2"	54	93	60	0,52
3/4"	58	103	70	0,63
1"	65	112	70	0,81
1.1/4"	74	125	80	1,18
1.1/2"	78	145	90	2,00
2"	87	170	100	2,82

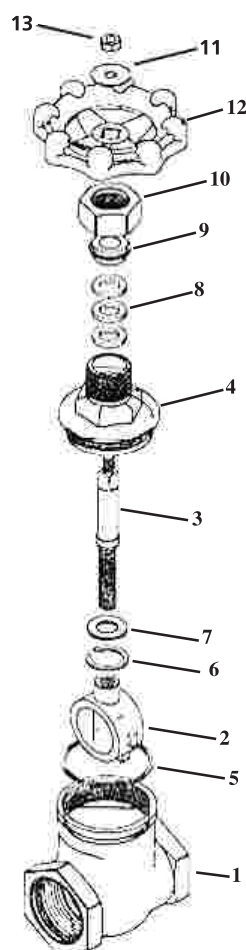
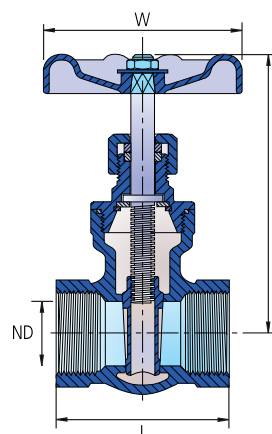

GENERAL CHARACTERISTICS:

- Investment casting.
- Metal / metal sealing.
- Full bore.
- High mechanical resistance.
- Low pressure drop.
- Two directional closure.
- Total tightness.
- Low torque output.
- Seats and packing made of high resistant Teflon.
- Low cost installation and maintenance.
- Temperature between 0°C and 205°C (depending on working pressure).

MATERIALS		
1	BODY	S.S. CF8M
2	DISC	S.S. CF8M
3	STEM	S.S. 316
4	BONNET	S.S. CF8M
5	JOINT	PTFE
6	SNAP FING	S.S. 304
7	PACKING STEM	S.S. 304
8	PACKING	PTFE
9	GLAND RING	S.S. 304
10	GLAND NUT	S.S. CF8M
11	WASHER	S.S. 304
12	HANDWHEEL	DUCTILE IRON
13	NUT	S.S. 304

